



COUNTY OF PRINCE WILLIAM

4379 Ridgewood Center Drive, Prince William, Virginia 22192-5308
(703) 792-6840 Metro 631-1703 Fax: (703) 792-7192

Office of Information
Technology
Geographic Information
Systems Division

Kathryn T. Prescott
Division Chief

April 5, 2005

TO: Interested Parties

FROM: Kathryn T. Prescott
Division Chief

RE: Address Re-assignment Information

Attached are address re-assignments which include identification information for properties within Prince William County. Action was taken in accordance with the Prince William County Code, Chapter 24, Article 2. Addresses were re-assigned in conformance with the uniform County-wide grid system.

By eliminating discrepancies in street names and addresses, the system is instrumental in providing information concerning the location of the property. This information is essential in providing quick and accurate Fire and Police protection, rescue service, and other emergency services required by County residents.

A letter of notification has been sent to property owners and tenants concerned with the address change within the past two weeks. At this time, County agencies, utility companies, and the U.S. Postal Service are being notified of this change. **Please note that the effective date of the address re-assignment is indicated on the printout.** Generally, the effective date is approximately two weeks from the date of this letter.

In the event that you have any questions, you are invited to visit the Geographic Information Systems Division at 4379 Ridgewood Center Drive, or call at **703-792-6840**.

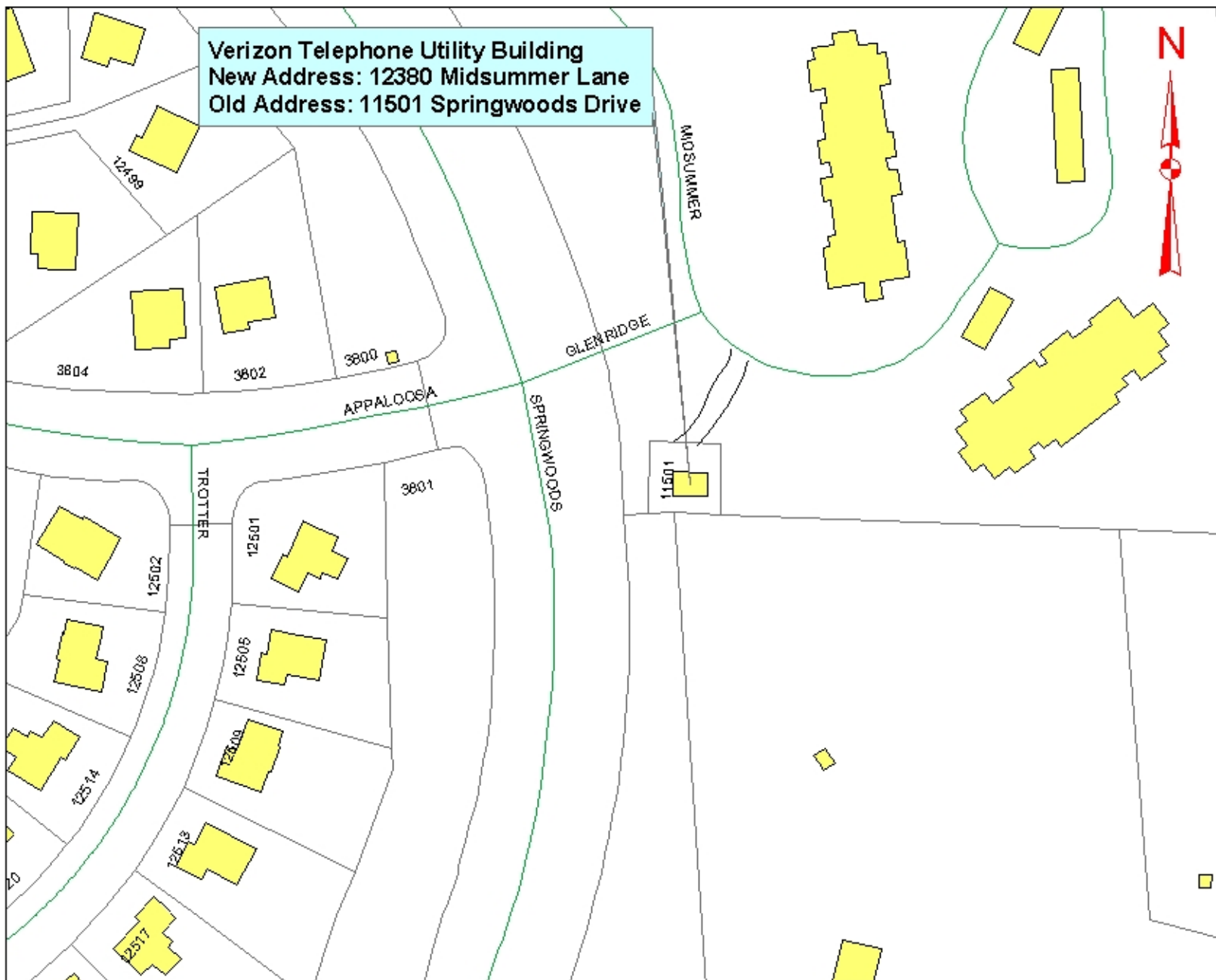

Address Reassignment

Prince William County, Virginia

| <i>Problem Code</i> | <i>Problem Description</i> |
|---------------------|---|
| 100 | Corner Lot - Address depends on location of driveway |
| 101 | Citizen accessing parcel via different route than originally addressed |
| 200 | Street Name Change - A renaming of existing street (BOCS Statement) |
| 201 | Street Name Change - realigning existing road and previously existing addresses disconnected (BOCS Statement) |
| 202 | Address change due to Road Realignment |
| 300 | Address - Out of sequence |
| 301 | Address - Odd on even "or" even on odd side of road |
| 302 | Address changed to what citizen is using |
| 303 | Multiple/Different Businesses in same Building or Lot - Addresses assigned to each |
| 304 | Duplicate addresses |
| 400 | Not enough addresses |
| 500 | Readdressing of complete street - Street name remains the same |
| 501 | Naming of an easement, addresses changed to that of easement |
| 502 | Duplicate street names |
| 600 | Address assigned to miscellaneous structure (not residential or commercial) |
| 700 | Database update |
| 800 | Other |

| <i>GPIN</i> | <i>Owner</i> | <i>Mailing Address</i> | <i>Old Parcel/Premise Address</i> | <i>New Parcel/Premise Address</i> | <i>Zipcode</i> | <i>Effective Date</i> | <i>Problem Code</i> |
|-------------|--------------|------------------------|-----------------------------------|-----------------------------------|----------------|-----------------------|---------------------|
|-------------|--------------|------------------------|-----------------------------------|-----------------------------------|----------------|-----------------------|---------------------|

Building Tpye: **COMMERCIAL**

| | | | | | | | |
|--------------|-------------------------------|--|-------------------|--------------------|----------|-----------|-----|
| 8193-84-9003 | VERIZON ATTN: DALE KIDGELL | 104 S CHURCH ST SMITHVILLE VA 23430 | 11501 SPRINGWOODS | DR 12380 MIDSUMMER | LN 22192 | 4/11/2005 | 101 |
|--------------|-------------------------------|--|-------------------|--------------------|----------|-----------|-----|