



COUNTY OF PRINCE WILLIAM

4379 Ridgewood Center Drive, Prince William, Virginia 22192-5308
(703) 792-6840 Metro 631-1703 Fax: (703) 792-7192

Office of Information
Technology
Geographic Information
Systems Division

Kathryn T. Prescott
Division Chief

August 4, 2006

TO: Interested Parties

FROM: Kathryn T. Prescott
Division Chief

RE: Address Re-assignment Information

Attached are address re-assignments which include identification information for properties within Prince William County. Action was taken in accordance with the Prince William County Code, Chapter 24, Article 2. Addresses were re-assigned in conformance with the uniform County-wide grid system.

By eliminating discrepancies in street names and addresses, the system is instrumental in providing information concerning the location of the property. This information is essential in providing quick and accurate Fire and Police protection, rescue service, and other emergency services required by County residents.

A letter of notification has been sent to property owners and tenants concerned with the address change within the past two weeks. At this time, County agencies, utility companies, and the U.S. Postal Service are being notified of this change. **Please note that the effective date of the address re-assignment is indicated on the printout.** Generally, the effective date is approximately two weeks from the date of this letter.

In the event that you have any questions, you are invited to visit the Geographic Information Systems Division at 4379 Ridgewood Center Drive, or call at **703-792-6840**.

Address Reassignment

Prince William County, Virginia

<i>Problem Code</i>	<i>Problem Description</i>
100	Corner Lot - Address depends on location of driveway
101	Citizen accessing parcel via different route than originally addressed
200	Street Name Change - A renaming of existing street (BOCS Statement)
201	Street Name Change - realigning existing road and previously existing addresses disconnected (BOCS Statement)
202	Address change due to Road Realignment
300	Address - Out of sequence
301	Address - Odd on even "or" even on odd side of road
302	Address changed to what citizen is using
303	Multiple/Different Businesses in same Building or Lot - Addresses assigned to each
304	Duplicate addresses
400	Not enough addresses
500	Readdressing of complete street - Street name remains the same
501	Naming of an easement, addresses changed to that of easement
502	Duplicate street names
600	Address assigned to miscellaneous structure (not residential or commercial)
700	Database update
800	Other

<i>GPIN</i>	<i>Owner</i>	<i>Mailing Address</i>	<i>Old Parcel/Premise Address</i>	<i>New Parcel/Premise Address</i>	<i>Zipcode</i>	<i>Effective Date</i>	<i>Problem Code</i>
Building Type: SINGLE FAMILY RESIDENTIAL							
7395-54-5579	RIGGS E. AND SUSAN E. WAGNER	14360 OWLS NEST ROAD NOKESVILLE VA 20181	14360 OWLS NEST	RD 9901 BELL WOOD FARM LN	20181	8/10/2006	501
7395-53-2921	YARBROUGH LUCIEN B. TR.	1549 OLD BRIDGE ROAD WOODBRIIDGE VA 22192	14304 OWLS NEST	RD 14170 OWLS NEST	RD 20181	8/10/2006	501
7395-44-5180	DOUGLAS E. & KENDRA G. POSEY	10831 PARK GATE DRIVE NOKESVILLE VA 20181	14370 OWLS NEST	RD 9900 BELL WOOD FARM LN	20181	8/10/2006	501
7395-09-7541	ROBIN L. CHACONAS MARTIN	14839 GLENSKIRK ROAD NOKESVILLE VA 20181	0	9250 CHACONAS	CT 20181	8/10/2006	501
7395-09-6568	ROBIN L. CHACONAS MARTIN	14839 GLENSKIRK ROAD NOKESVILLE VA 20181	14839 GLENKIRK	RD 9260 CHACONAS	CT 20181	8/10/2006	501
Building Type: VACANT							
7395-43-0604	MARY WOOD GOUGH	14220 OWLS NEST ROAD NOKESVILLE VA 20181	14390 OWLS NEST	RD 14300 OWLS NEST	RD 20181	8/10/2006	501
7395-34-6376	SARAH W. BURKE AND TRUSTEES	14219 OWLS NEST ROAD NOKESVILLE VA 20181	0	14380 OWLS NEST	RD 20181	8/10/2006	501
7395-34-7327	SARAH W. BURKE AND TRUSTEES	14219 OWLS NEST ROAD NOKESVILLE VA 20181	0	14370 OWLS NEST	RD 20181	8/10/2006	501
7395-33-4686	SARAH W. BURKE AND TRUSTEES	14219 OWLS NEST ROAD NOKESVILLE VA 20181	0	14360 OWLS NEST	RD 20181	8/10/2006	501
7395-33-1318	SARAH W. BURKE AND TRUSTEES	14219 OWLS NEST ROAD NOKESVILLE VA 20181	0	14340 OWLS NEST	RD 20181	8/10/2006	501

<i>GPIN</i>	<i>Owner</i>	<i>Mailing Address</i>	<i>Old Parcel/Premise Address</i>	<i>New Parcel/Premise Address</i>	<i>Zipcode</i>	<i>Effective Date</i>	<i>Problem Code</i>
7395-33-6009	SARAH W. BURKE AND TRUSTEES	14219 OWLS NEST ROAD NOKESVILLE VA 20181	0	14320 OWLS NEST	RD 20181	8/10/2006	501
7395-43-4250	SARAH W. BURKE AND TRUSTEES	14219 OWLS NEST ROAD NOKESVILLE VA 20181	0	9936 BELL WOOD FARM LN	20181	8/10/2006	501
7395-44-6532	SARAH W. BURKE AND TRUSTEES	14219 OWLS NEST ROAD NOKESVILLE VA 20181	0	9914 BELL WOOD FARM LN	20181	8/10/2006	501
7395-54-5037	SARAH W. BURKE AND TRUSTEES	14219 OWLS NEST ROAD NOKESVILLE VA 20181	14324 OWLS NEST	RD 9915 BELL WOOD FARM LN	20181	8/10/2006	501
7395-53-4085	SARAH W. BURKE AND TRUSTEES	14219 OWLS NEST ROAD NOKESVILLE VA 20181	14314 OWLS NEST	RD 14150 OWLS NEST	RD 20181	8/10/2006	501

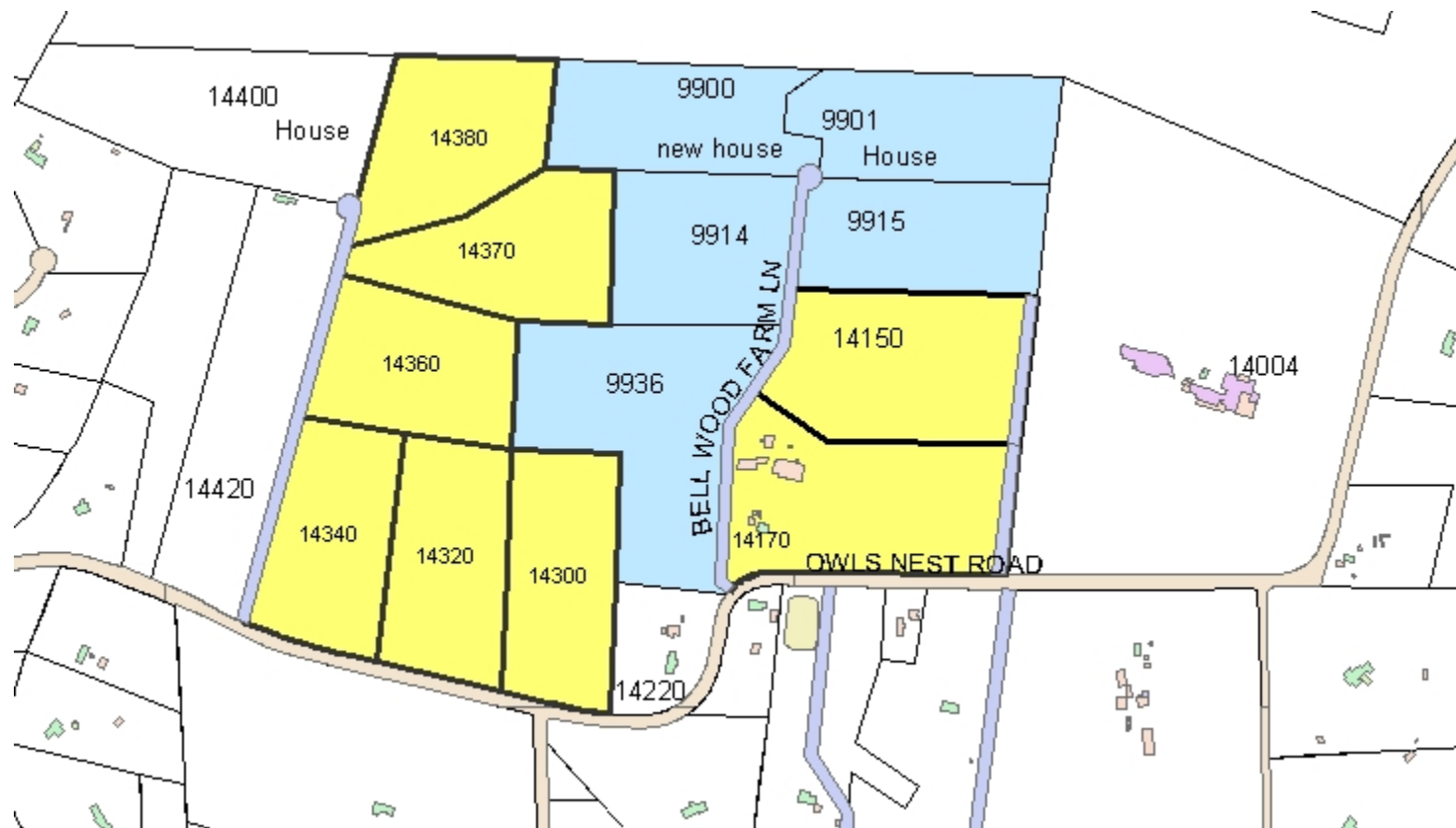

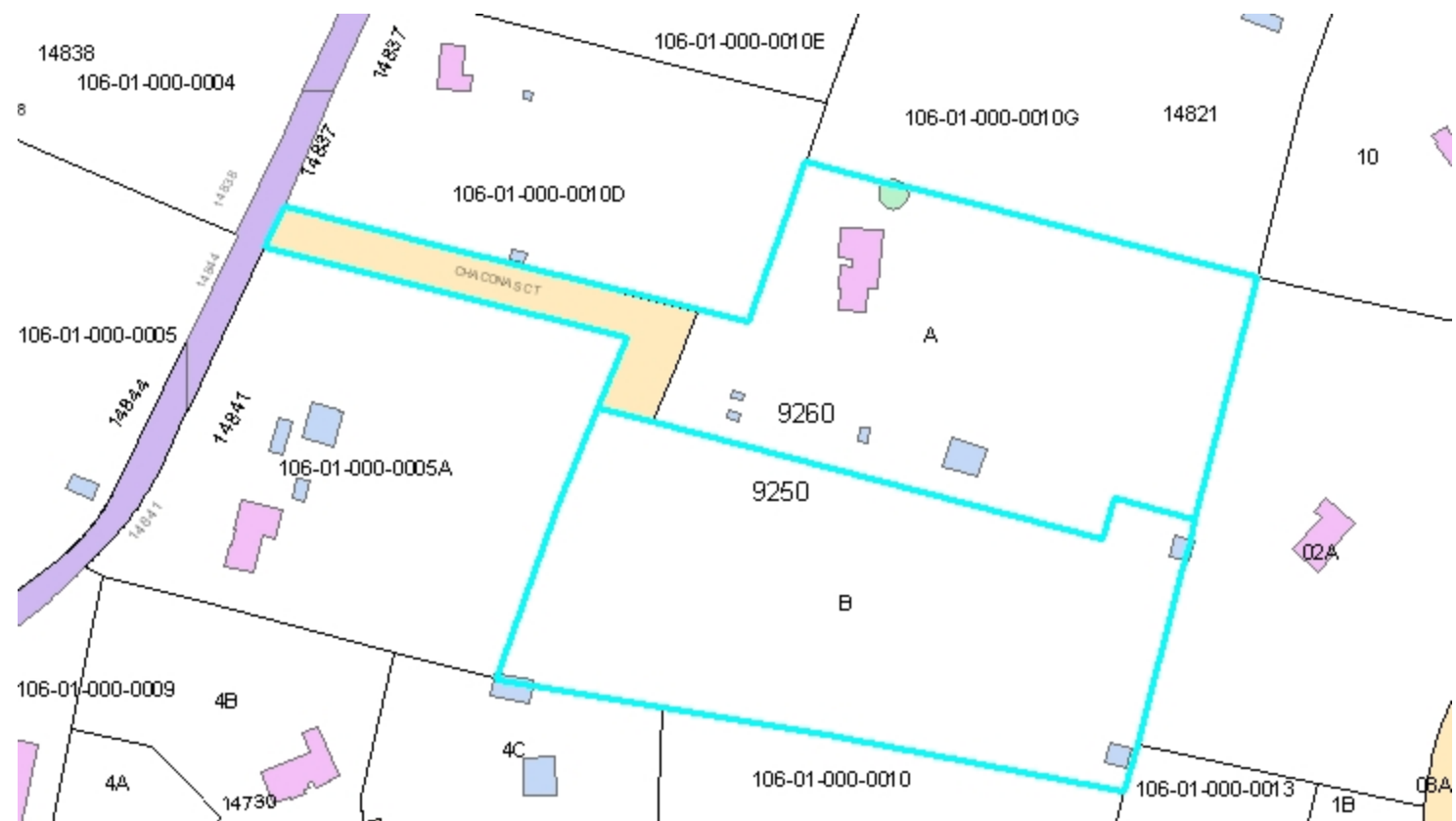

<i>GPIN</i>	<i>Owner</i>	<i>Mailing Address</i>	<i>Old Parcel/Premise Address</i>	<i>New Parcel/Premise Address</i>	<i>Zipcode</i>	<i>Effective Date</i>	<i>Problem Code</i>
<i>Building Type: COMMERCIAL</i>							
7396-44-8029	PWC SCHOOL BOARD, ATTN: CHERYL DUTTON	14800 JOPLIN RD BLD 56 MANASSAS VA 20112	8584 SEDGE WREN	CT 8584 SEDGE WREN	DR 20155	8/2/2006	700
<i>Building Type: SINGLE FAMILY RESIDENTIAL</i>							
7396-54-1459	BROOKFIELD MORRIS LLC	8500 EXECUTIVE PARK AVE STE 300 FAIRFAX VA 22031	8581 SEDGE WREN	CT 8581 SEDGE WREN	DR 20155	8/2/2006	700
7396-54-1956	BROOKFIELD MORRIS LLC	8500 EXECUTIVE PARK AVE STE 300 FAIRFAX VA 22031	8585 SEDGE WREN	CT 8585 SEDGE WREN	DR 20155	8/2/2006	700
7396-54-2454	BROOKFIELD MORRIS LLC	8500 EXECUTIVE PARK AVE STE 300 FAIRFAX VA 22031	8589 SEDGE WREN	CT 8589 SEDGE WREN	DR 20155	8/2/2006	700
7396-54-3051	BROOKFIELD MORRIS LLC	8500 EXECUTIVE PARK AVE STE 300 FAIRFAX VA 22031	8593 SEDGE WREN	CT 8593 SEDGE WREN	DR 20155	8/2/2006	700
7396-54-3447	BROOKFIELD MORRIS LLC	8500 EXECUTIVE PARK AVE STE 300 FAIRFAX VA 22031	8597 SEDGE WREN	CT 8597 SEDGE WREN	DR 20155	8/2/2006	700
7396-54-3841	BROOKFIELD MORRIS LLC	8500 EXECUTIVE PARK AVE STE 300 FAIRFAX VA 22031	8601 SEDGE WREN	CT 8601 SEDGE WREN	DR 20155	8/2/2006	700
7396-54-4135	BROOKFIELD MORRIS LLC	8500 EXECUTIVE PARK AVE STE 300 FAIRFAX VA 22031	8605 SEDGE WREN	CT 8605 SEDGE WREN	DR 20155	8/2/2006	700
7396-54-4330	BROOKFIELD MORRIS LLC	8500 EXECUTIVE PARK AVE STE 300 FAIRFAX VA 22031	8609 SEDGE WREN	CT 8609 SEDGE WREN	CT 20155	8/2/2006	700
7396-54-4905	BROOKFIELD MORRIS LLC	8500 EXECUTIVE PARK DR STE 300 FAIRFAX VA 22031	8625 SEDGE WREN	CT 8625 SEDGE WREN	DR 20155	8/2/2006	700
7396-53-4996	BROOKFIELD MORRIS LLC	8500 EXECUTIVE PARK AVE STE 300 FAIRFAX VA 22031	8629 SEDGE WREN	CT 8629 SEDGE WREN	DR 20155	8/2/2006	700

