



COUNTY OF PRINCE WILLIAM

5 County Complex Court, Suite 140, Prince William, Virginia 22192-5308
(703) 792-6840 Metro (703) 631-1703 Fax: (703) 792-7192

Office of Information
Technology
Geographic Information
Systems Division

Kathryn T. Prescott
Division Chief

May 24, 2007

TO: Interested Parties

FROM: Kathryn T. Prescott
Division Chief

RE: Address Re-assignment Information

Attached are address re-assignments which include identification information for properties within Prince William County. Action was taken in accordance with the Prince William County Code, Chapter 24, Article 2. Addresses were re-assigned in conformance with the uniform County-wide grid system.

By eliminating discrepancies in street names and addresses, the system is instrumental in providing information concerning the location of the property. This information is essential in providing quick and accurate Fire and Police protection, rescue service, and other emergency services required by County residents.

A letter of notification has been sent to property owners and tenants concerned with the address change within the past two weeks. At this time, County agencies, utility companies, and the U.S. Postal Service are being notified of this change. **Please note that the effective date of the address re-assignment is indicated on the printout.** Generally, the effective date is approximately two weeks from the date of this letter.

In the event that you have any questions, you are invited to visit the Geographic Information Systems Division at 5 Country Complex Ct, Suite 140, Woodbridge, VA 22192, or call at **703-792-6840**.

Address Reassignment

Prince William County, Virginia

<i>Problem Code</i>	<i>Problem Description</i>
100	Corner Lot - Address depends on location of driveway
101	Citizen accessing parcel via different route than originally addressed
200	Street Name Change - A renaming of existing street (BOCS Statement)
201	Street Name Change - realigning existing road and previously existing addresses disconnected (BOCS Statement)
202	Address change due to Road Realignment
300	Address - Out of sequence
301	Address - Odd on even "or" even on odd side of road
302	Address changed to what citizen is using
303	Multiple/Different Businesses in same Building or Lot - Addresses assigned to each
304	Duplicate addresses
400	Not enough addresses
500	Readdressing of complete street - Street name remains the same
501	Naming of an easement, addresses changed to that of easement
502	Duplicate street names
600	Address assigned to miscellaneous structure (not residential or commercial)
700	Database update
800	Other

GPIN	Owner	Mailing Address	Old Parcel/Premise Address	New Parcel/Premise Address	Zipcode	Effective Date	Problem Code
------	-------	-----------------	----------------------------	----------------------------	---------	----------------	--------------

Building Type: COMMERCIAL

8092-00-8209	TRUSTEES GRACE BAPTIST CHURCH	14242 SPRIGGS BRANCH RD WOODBIDGE VA 22193	14242 SPRIGGS BRANCH	RD 14242 SPRIGGS (ADDRESS CHANGE	RD 22193	5/17/2007	800
--------------	----------------------------------	---	----------------------	--	----------	-----------	-----

Recinded from 3/19/2007 address reassignment for Grace Baptist Church.

Building Type: SINGLE FAMILY RESIDENTIAL

8289-12-6933	PROPERTY PROCUREMENT INC	17658 ROSE HILL CIRCLE DUMFRIES VA 22026	17658 ROSE HILL	CL 3423 HOWARD	ST 22026	5/21/2007	101
--------------	-----------------------------	---	-----------------	----------------	----------	-----------	-----

Town of Dumfries address change

Building Type: COMMERCIAL

8093-10-1130	JOHN PAUL I KNIGHTS COLUMBUS CHARITY CORP	P O BOX 2072 WOODBIDGE VA 22195	6001 HOADLY	RD 12965 TRENTDALE	DR 22193	5/23/2007	100
--------------	---	------------------------------------	-------------	--------------------	----------	-----------	-----

The Knights of Columbus, located on the corner of Hoadly Rd and Trentdale Dr is changing their driveway entrance from Hoadly to Trentdale, so the address must change to 12965 Trentdale Drive.

Grace Baptist Church address change from 14242 Spriggs Road to 14242 Spriggs Branch Road recinded. 14242 Spriggs Road will be the address used by Grace Baptist Church.

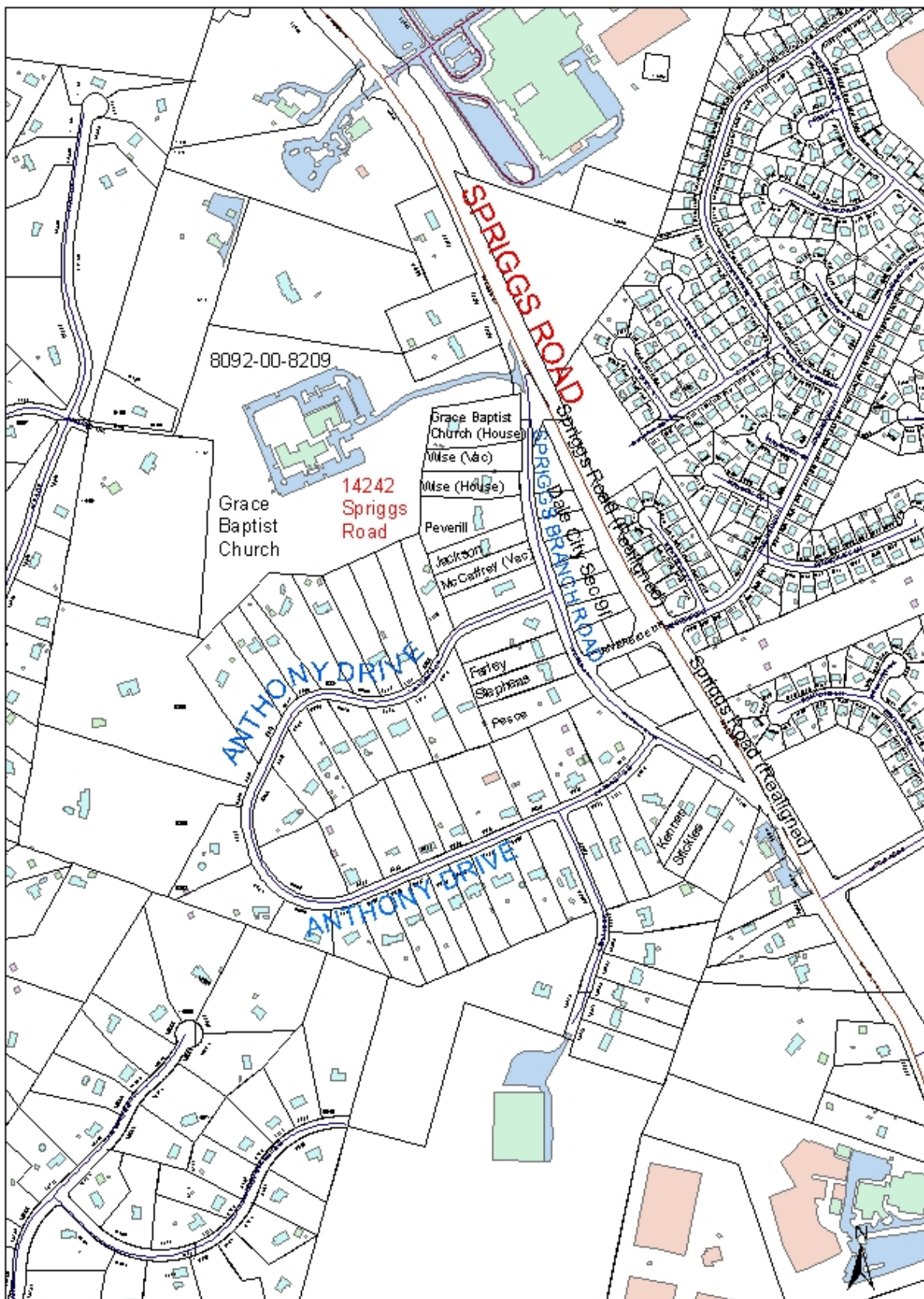

**DUMFRIES, VIRGINIA**

Virginia's Oldest Continuously Chartered Town

CHARTERED 1749 INCORPORATED 1961

17755 Main Street / P.O. Box 56
Dumfries, Virginia 22026-0056
Tel. 703-221-3400 / Fax 703-221-3544
www.DumfriesVirginia.org

May 18, 2007

Property Procurement Inc.
Attn: David Faught
4100 Trevor Lane
Woodbridge, VA 22191RE: Address change for 17658 Rose hill Circle, Dumfries, VA 22026
GPIN # 828912-6933 **8289-12-6933**

Dear Mr. Faught;

Due to some confusion with the addressing to the current property located at 17658 Rose Hill Circle, We will be re addressing the parcel and be using the address of 3423 Howard Street.

If you have any questions regarding the change, please feel free to contact me at (703)221-3400 ext 119 or Linda.frye@dumfriesvirginia.org.

Sincerely,

Linda Frye
Building Official
Town of DumfriesCC: PWC GIS Dept
PWC Communications
File

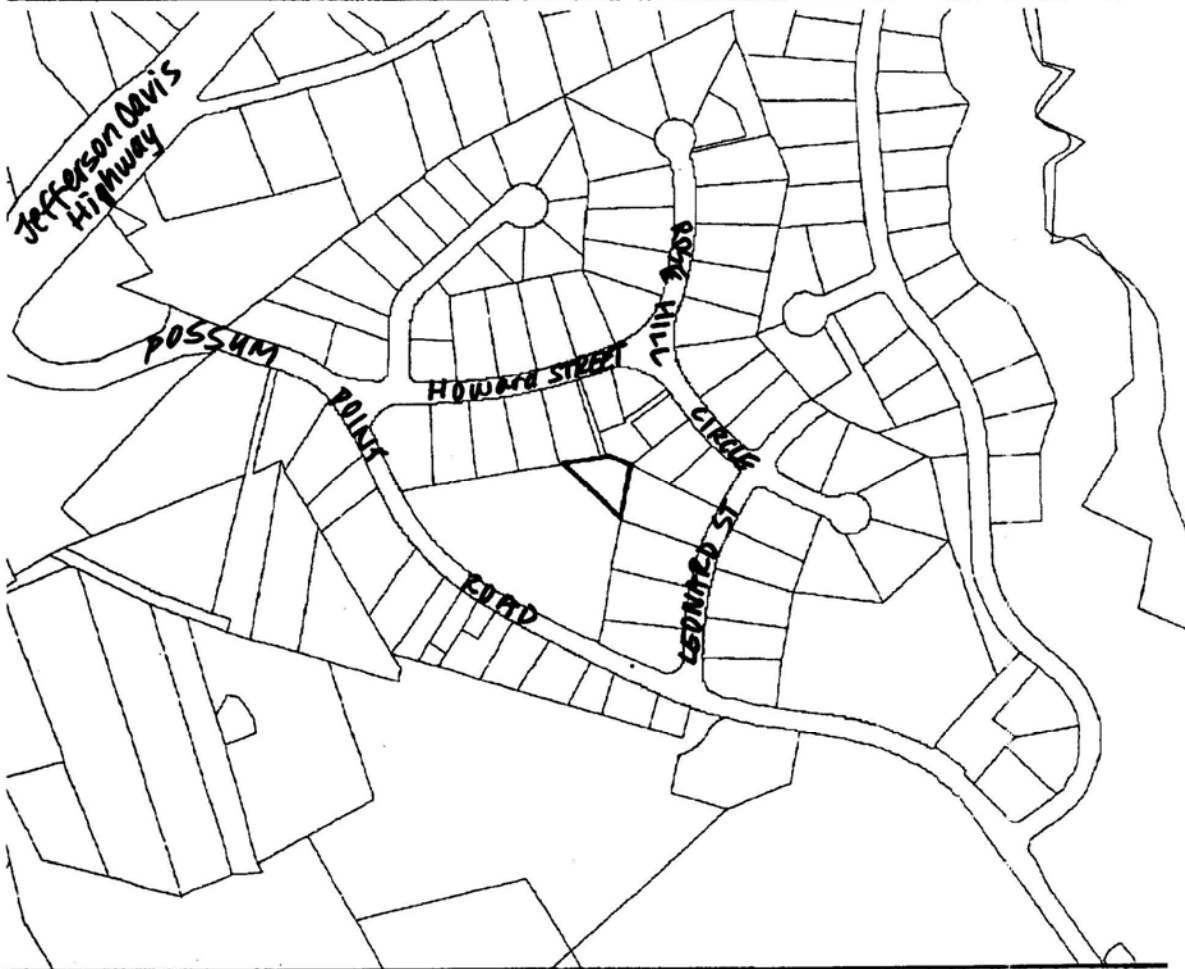
TOWN OF DUMFRIES**17755 MAIN STREET PO BOX 56 DUMFRIES VA, 220260056****Ph: (703) 221-3400 Fax: (703) 221-3544**

DISCLAIMER: This map is intended for property tax assessment purposes only. The information contained on this map is based upon recorded deeds, plans, and other public sources. These primary sources should be consulted to verify the information contained on this map. Due to conflicts, errors, and omissions in the primary sources, the tax map should be considered to be a representation of the editor's judgment, based upon the available evidence. Tax maps are not legal evidence of size, shape, location, or ownership of real estate, roads, or municipal boundaries.

THE TOWN OF DUMFRIES ASSUMES NO LIABILITY RELATED TO THE USE OF THIS MAP. THIS MAP IS NOT A SURVEY.





driveway
ance removed

NOTES:

1. PROPERTY OWNER: JOHN PAUL I CHARITY CORPORATION
 0551 CANTLEYVER COURT
 WOODBRIDGE, VA 22192
2. PROPERTY GPM: 8029-10-153
3. EX. PROPERTY ADDRESS: 6001 HOADLY ROAD
 NEW PROPERTY ADDRESS: 12965 TRENTDALE DRIVE
4. PROPERTY ZONING: RPC
 PROPERTY USE: CIVIC CLUB

SITE TABULATIONS:

TOTAL PROJECT AREA:	136,674 SQ. FT. OR 3.1374 AC.
TOTAL BUILDING AREA:	7,495 SQ. FT.
SITE P.A.R.:	0.054
IMPERVIOUS AREA:	36,210 SQ. FT. OR 0.83 AC. (261)
NON-IMPERVIOUS AREA:	100,464 SQ. FT. OR 2.31 AC. (748)

PARKING TABULATION (CIVIC CLUB)

EX. BUILDING/PARKING
 (4,326 N.S.F. / 100 = 44 SPACES REQ'D.)

EXISTING PARKING = 61 SPACE

PROPOSED BUILDING:
 (5,771 N.S.F. / 100 = 58 SPACES REQ'D.)

REGULAR PARKING PROVIDED =	70 SPACE
HANDICAP PARKING PROVIDED =	3 SPACE
TOTAL PARKING PROVIDED =	73 SPACE

LOADING SPACES REQ'D. = 1 SPACE
 LOADING SPACES PROVIDED = 1 SPACE



GRAPHIC SCALE



(IN FEET)
 1 inch = 30 ft.

New address
12965 Trentdale Drive

COMMONWEALTH OF VIRGINIA
THOMAS O. ROBBINS
No. 14529
PROFESSIONAL ENGINEER

GRAPHIC SCALE

[illegible]

<i>GPIN</i>	<i>Owner</i>	<i>Mailing Address</i>	<i>Old Parcel/Premise Address</i>	<i>New Parcel/Premise Address</i>	<i>Zipcode</i>	<i>Effective Date</i>	<i>Problem Code</i>
<i>Building Type: COMMERCIAL</i>							
7695-02-6950	MR. AND MRS. FRANK ELLISON	3689 WAPLES CREST CT OAKTON VA 22124	10111 RESIDENCY Suite A	RD 10111 RESIDENCY Suite 101	RD 20110	6/4/2007	303
7695-02-6950	MR. & MRS. FRANK ELLISON	3689 WAPLES CREST CT OAKTON VA 22124	10111 RESIDENCY Suite B	RD 10111 RESIDENCY Suite 102	RD 20110	6/4/2007	303
7695-02-6950	MR. AND MRS. FRANK ELLISON	3689 WAPLES CREST CT OAKTON VA 22124	10111 RESIDENCY Suite B	RD 10111 RESIDENCY Suite 103	RD 20110	6/4/2007	303
7695-02-6950	MR. AND MRS. FRANK ELLISON	3689 WAPLES CREST CT OAKTON VA 22124	10111 RESIDENCY Suite B	RD 10111 RESIDENCY Suite 104	RD 20110	6/4/2007	303
7695-02-6950	MR. AND MRS. FRANK ELLISON	3689 WAPLES CREST CT OAKTON VA 22124	10111 RESIDENCY Suite B	RD 10111 RESIDENCY Suite 105	RD 20110	6/4/2007	303
7695-02-6950	MR. AND MRS. FRANK ELLISON	3689 WAPLES CREST CT OAKTON VA 22124	10111 RESIDENCY Suite B	RD 10111 RESIDENCY Suite 106	RD 20110	6/4/2007	303
7695-02-6950	MR. AND MRS. FRANK ELLISON	3689 WAPLES CREST CT OAKTON VA 22124	10111 RESIDENCY Suite B	RD 10111 RESIDENCY Suite 107	RD 20110	6/4/2007	303

