



COUNTY OF PRINCE WILLIAM

5 County Complex Court, Suite 140, Prince William, Virginia 22192-9201
(703) 792-6840 Metro (703) 631-1703 Fax: (703) 792-7192

Department of Information
Technology
GIS Division

Angela H. Mills
GIS Division Chief

January 21, 2014

TO: Interested Parties

FROM: Angela H. Mills
GIS Division Chief

RE: Address Re-assignment Information

Attached are address re-assignments which include identification information for properties within Prince William County. Action was taken in accordance with the Prince William County Code, Chapter 24, Article 2. Addresses were re-assigned in conformance with the uniform County-wide grid system.

By eliminating discrepancies in street names and addresses, the system is instrumental in providing information concerning the location of the property. This information is essential in providing quick and accurate Fire and Police protection, rescue service, and other emergency services required by County residents.

A letter of notification has been sent to property owners and tenants concerned with the address change within the past two weeks. At this time, County agencies, utility companies, and the U.S. Postal Service are being notified of this change. **Please note that the effective date of the address re-assignment is indicated on the printout.** Generally, the effective date is approximately two weeks from the date of this letter.

In the event that you have any questions, you are invited to visit the Geographic Information Systems at 5 Country Complex Ct, Suite 140, Woodbridge, VA 22192, or call at **703-792-6840**.

Address Reassignment

Prince William County, Virginia

<i>Problem Code</i>	<i>Problem Description</i>
100	Corner Lot - Address depends on location of driveway
101	Citizen accessing parcel via different route than originally addressed
200	Street Name Change - A renaming of existing street (BOCS Statement)
201	Street Name Change - realigning existing road and previously existing addresses disconnected (BOCS Statement)
202	Address change due to Road Realignment
300	Address - Out of sequence
301	Address - Odd on even "or" even on odd side of road
302	Address changed to what citizen is using
303	Multiple/Different Businesses in same Building or Lot - Addresses assigned to each
304	Duplicate addresses
400	Not enough addresses
500	Readdressing of complete street - Street name remains the same
501	Naming of an easement, addresses changed to that of easement
502	Duplicate street names
600	Address assigned to miscellaneous structure (not residential or commercial)
700	Database update
800	Other

<i>GPIN</i>	<i>Owner</i>	<i>Mailing Address</i>	<i>Old Parcel/Premise Address</i>	<i>New Parcel/Premise Address</i>	<i>Zipcode</i>	<i>Effective Date</i>	<i>Problem Code</i>
<i>Building Type: RESIDENTIAL</i>							
8192-87-8766	JULIUS & LILA BRANSCOME	3809 RUSSELL RD WOODBIDGE, VA 22192	3807 RUSSELL RD WOODBIDGE, VA 22192	3799 RUSSELL RD WOODBIDGE, VA 22192	22192	1/31/2014	300
8192-87-5250	DAVID & PATRICIA BRANSCOME	3817 RUSSELL RD WOODBIDGE, VA 22192	3817 RUSSELL RD WOODBIDGE, VA 22192	3807 RUSSELL RD WOODBIDGE, VA 22192	22192	1/31/2014	300
8192-87-6059	THOMAS S. BRANSCOME	3813 RUSSELL RD WOODBIDGE, VA 22192	3813 RUSSELL RD WOODBIDGE, VA 22192	3803 RUSSELL RD WOODBIDGE, VA 22192	22192	1/31/2014	300
8192-87-6478	KATHY J. BOWMAN	3805 RUSSELL RD WOODBIDGE, VA 22192	3805 RUSSELL RD WOODBIDGE, VA 22192	3801 RUSSELL RD WOODBIDGE, VA 22192	22192	1/31/2014	300

RUSSELL ROAD ADDRESS REASSIGNMENTS

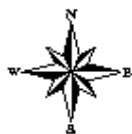

Old Address: 3805 Russell Road
New Address: 3801 Russell Road
GPIN: 8192-87-6478

Old Address: 3807 Russell Road
New Address: 3799 Russell Road
GPIN: 8192-87-8766
(Vacant Lot)

Old Address: 3817 Russell Road
New Address: 3807 Russell Road
GPIN: 8192-87-5250

Old Address: 3813 Russell Road
New Address: 3803 Russell Road
GPIN: 8192-87-6059

Existing Address: 3809 Russell Road
GPIN: 8192-87-3938
(Will remain the same)

<i>GPIN</i>	<i>Owner</i>	<i>Mailing Address</i>	<i>Old Parcel/Premise Address</i>	<i>New Parcel/Premise Address</i>	<i>Zipcode</i>	<i>Effective Date</i>	<i>Problem Code</i>
--------------------	---------------------	-------------------------------	--	--	-----------------------	------------------------------	----------------------------

Building Tpye: **SINGLE FAMILY RESIDENTIAL**

7995-04-6073	QARGHA SAIFURRAHMAN ETAL	7201 SIGNAL HILL RD MANASSAS VA 20111	7201 SIGNAL HILL	RD 9978 MARIAN	DR 20111	1/24/2014	101
--------------	-----------------------------	--	------------------	----------------	----------	-----------	-----

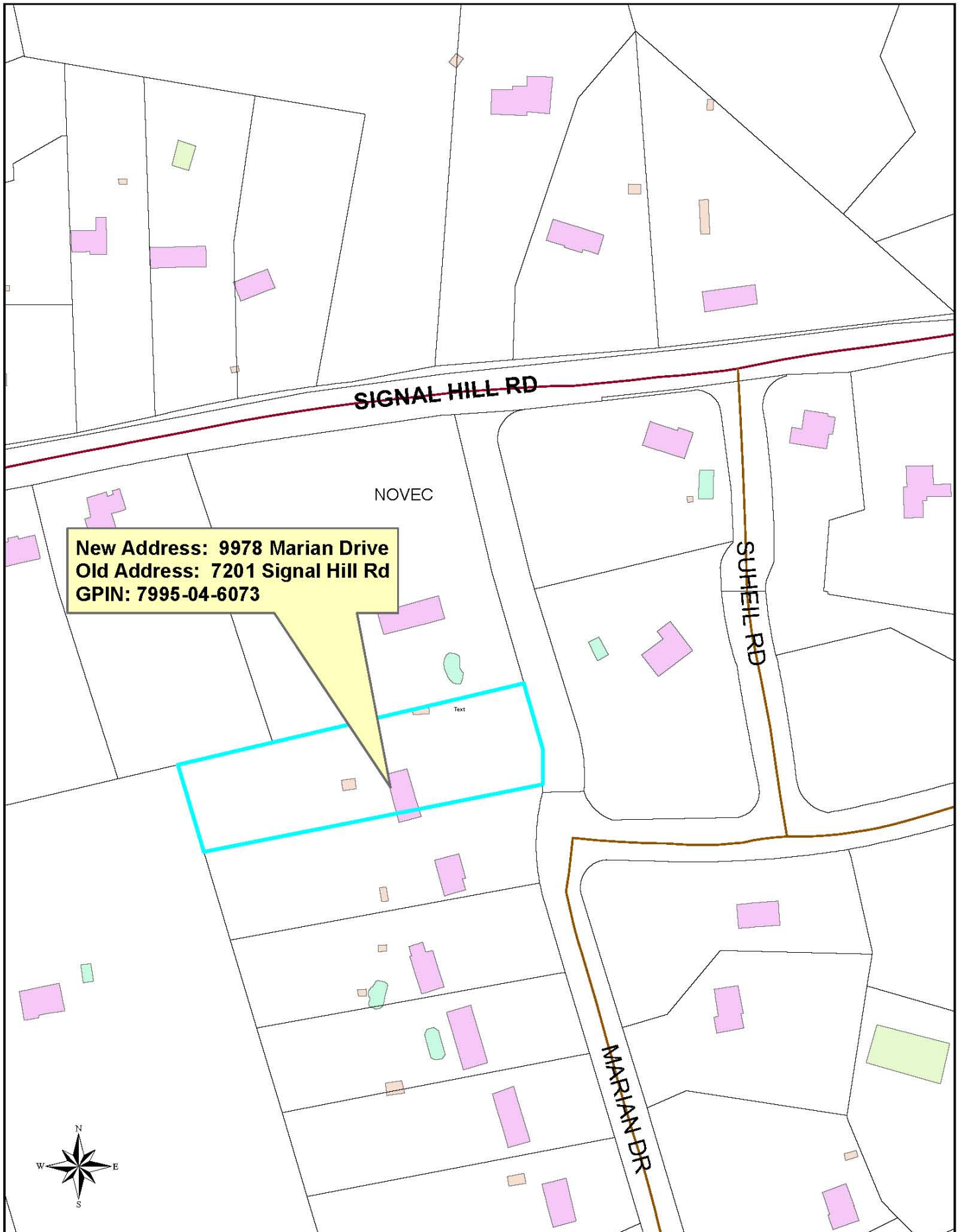

New Address: 9978 Marian Drive
Old Address: 7201 Signal Hill Rd
GPIN: 7995-04-6073