



COUNTY OF PRINCE WILLIAM

5 County Complex Court, Suite 140, Prince William, Virginia 22192-9201
(703) 792-6840 Metro (703) 631-1703 Fax: (703) 792-7192

Department of Information
Technology
Customer Services and
Solutions Division

Kathryn T. Prescott
Division Chief

February 14, 2012

TO: Interested Parties

FROM: Kathryn T. Prescott
Division Chief

RE: Address Re-assignment Information

Attached are address re-assignments which include identification information for properties within Prince William County. Action was taken in accordance with the Prince William County Code, Chapter 24, Article 2. Addresses were re-assigned in conformance with the uniform County-wide grid system.

By eliminating discrepancies in street names and addresses, the system is instrumental in providing information concerning the location of the property. This information is essential in providing quick and accurate Fire and Police protection, rescue service, and other emergency services required by County residents.

A letter of notification has been sent to property owners and tenants concerned with the address change within the past two weeks. At this time, County agencies, utility companies, and the U.S. Postal Service are being notified of this change. **Please note that the effective date of the address re-assignment is indicated on the printout.** Generally, the effective date is approximately two weeks from the date of this letter.

In the event that you have any questions, you are invited to visit the Geographic Information Systems at 5 Country Complex Ct, Suite 140, Woodbridge, VA 22192, or call at **703-792-6840**.

Address Reassignment

Prince William County, Virginia

<i>Problem Code</i>	<i>Problem Description</i>
100	Corner Lot - Address depends on location of driveway
101	Citizen accessing parcel via different route than originally addressed
200	Street Name Change - A renaming of existing street (BOCS Statement)
201	Street Name Change - realigning existing road and previously existing addresses disconnected (BOCS Statement)
202	Address change due to Road Realignment
300	Address - Out of sequence
301	Address - Odd on even "or" even on odd side of road
302	Address changed to what citizen is using
303	Multiple/Different Businesses in same Building or Lot - Addresses assigned to each
304	Duplicate addresses
400	Not enough addresses
500	Readdressing of complete street - Street name remains the same
501	Naming of an easement, addresses changed to that of easement
502	Duplicate street names
600	Address assigned to miscellaneous structure (not residential or commercial)
700	Database update
800	Other

GPIN	Owner	Mailing Address	Old Parcel/Premise Address	New Parcel/Premise Address	Zipcode	Effective Date	Problem Code
------	-------	-----------------	----------------------------	----------------------------	---------	----------------	--------------

Building Tpye: COMMERCIAL

7991-06-2305	MITCHELL L. PHELPS INC.	14570 LEILANI DRIVE WOODBIDGE VA 22193	14843 DUMFRIES	RD 14843 DUMFRIES Suite 104 D&P Auto Parts	RD 20112	2/17/2012	303
7991-06-2305	MITCHELL L. PHELPS INC.	14570 LEILANI DRIVE WOODBIDGE VA 22193	14843 DUMFRIES	RD 14843 DUMFRIES suite 103 vacant	RD 20112	2/17/2012	303
7991-06-2305	MITCHELL L. PHELPS INC.	14570 LELANI DRIVE WOODBIDGE VA 22193	14843 DUMFRIES	RD 14843 DUMFRIES suite 102 olander Banks	RD 20112	2/17/2012	303
7991-06-2305	MITCHELL L. PHELPS INC.	14570 LEILANI DR WOODBIDGE VA 22193	14821 DUMFRIES	RD 14843 DUMFRIES Suite 101 Japanese Auto Salvage LLC	RD 20112	2/17/2012	303

Auto Salvage Yard
14843 Dumfries Rd

each tenant occupies part of the office & part of the salvage yard. see below for office & attached for Salvage area for each tenant

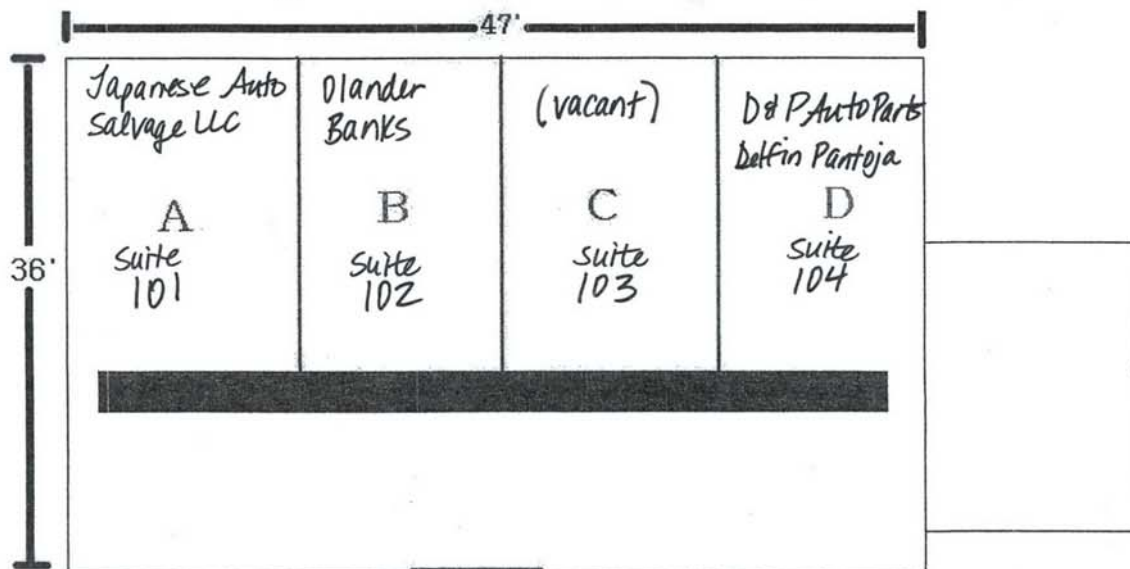

Auto Salvage Yard at 14843 Dumfries Road, Manassas, VA 20112

GPIN 7991-06-2305, 16.6866 acre single parcel

Shared Office with Suites 101, 102, 103, & 104, and Auto Salvage Yard Area for each Tenant

