



COUNTY OF PRINCE WILLIAM

5 County Complex Court, Suite 140, Prince William, Virginia 22192-9201
(703) 792-6840 Metro (703) 631-1703 Fax: (703) 792-7192

Department of Information
Technology
Customer Services and
Solutions Division

Kathryn T. Prescott
Division Chief

October 14, 2011

TO: Interested Parties

FROM: Kathryn T. Prescott
Division Chief

RE: Address Re-assignment Information

Attached are address re-assignments which include identification information for properties within Prince William County. Action was taken in accordance with the Prince William County Code, Chapter 24, Article 2. Addresses were re-assigned in conformance with the uniform County-wide grid system.

By eliminating discrepancies in street names and addresses, the system is instrumental in providing information concerning the location of the property. This information is essential in providing quick and accurate Fire and Police protection, rescue service, and other emergency services required by County residents.

A letter of notification has been sent to property owners and tenants concerned with the address change within the past two weeks. At this time, County agencies, utility companies, and the U.S. Postal Service are being notified of this change. **Please note that the effective date of the address re-assignment is indicated on the printout.** Generally, the effective date is approximately two weeks from the date of this letter.

In the event that you have any questions, you are invited to visit the Geographic Information Systems at 5 Country Complex Ct, Suite 140, Woodbridge, VA 22192, or call at **703-792-6840**.

Address Reassignment

Prince William County, Virginia

<i>Problem Code</i>	<i>Problem Description</i>
100	Corner Lot - Address depends on location of driveway
101	Citizen accessing parcel via different route than originally addressed
200	Street Name Change - A renaming of existing street (BOCS Statement)
201	Street Name Change - realigning existing road and previously existing addresses disconnected (BOCS Statement)
202	Address change due to Road Realignment
300	Address - Out of sequence
301	Address - Odd on even "or" even on odd side of road
302	Address changed to what citizen is using
303	Multiple/Different Businesses in same Building or Lot - Addresses assigned to each
304	Duplicate addresses
400	Not enough addresses
500	Readdressing of complete street - Street name remains the same
501	Naming of an easement, addresses changed to that of easement
502	Duplicate street names
600	Address assigned to miscellaneous structure (not residential or commercial)
700	Database update
800	Other

GPIN	Owner	Mailing Address	Old Parcel/Premise Address	New Parcel/Premise Address	Zipcode	Effective Date	Problem Code
Building Type: COMMERCIAL							
8393-51-4355.0	CHRISTIAN J & SONIA E KERGE	P O BOX 2701 SPRINGFIELD VA 22152	12774 DARBY BROOKE	CT 12778 DARBY BROOKE	CT 22192	10/7/2011	800

Brooke Centre Professional Center Condominiums, Ph 1, Unit N2

Request of owner, for address change, new tenant Dalestone Jewelry.

Brook Centre Professional Center Condos, Phase 1, Unit N2 address change

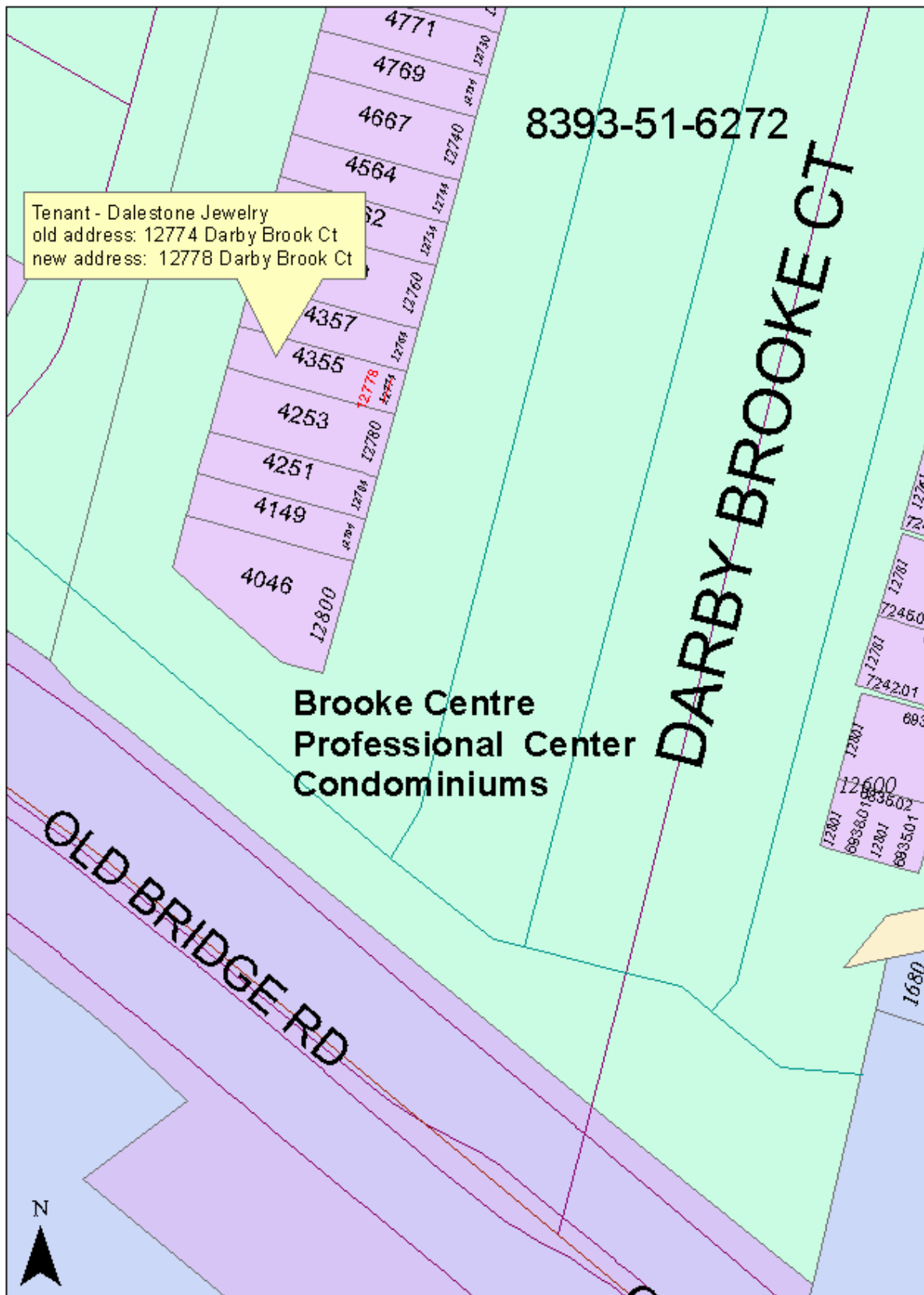

<u>GPIN</u>	<u>Owner</u>	<u>Mailing Address</u>	<u>Old Parcel/Premise Address</u>	<u>New Parcel/Premise Address</u>	<u>Zipcode</u>	<u>Effective Date</u>	<u>Problem Code</u>
-------------	--------------	------------------------	-----------------------------------	-----------------------------------	----------------	-----------------------	---------------------

Building Tpye: VACANT

7992-27-3684	RANDALL & KARLA COKER	59 CLARK LANE STAFFORD VA 22554	13119 KAHNS	RD 13212 TRAILS END	CT 20112	10/14/2011	101
--------------	--------------------------	------------------------------------	-------------	---------------------	----------	------------	-----

parcel is currently vacant, house will be built in near future, driveway will be on Trails End Court.

